

**TRUST
THE
ORIGINAL**

BNC Connectors



NEUTRIK®

| Content | Page |
|---|------|
| UHD BNC - rearTWIST Cable Connectors | 4 |
| HD BNC - rearTWIST Cable Connectors | 5 |
| Cable to Connector Guide | 6 |
| Argosy Image | 6 |
| Belden | 6 |
| CAE | 6 |
| Canare | 7 |
| Canford | 7 |
| Clark | 7 |
| Commscope | 7 |
| Cordial | 7 |
| Draka Multimedia Cable | 8 |
| Direct Cable | 8 |
| Kabeltronic | 8 |
| KLOTZ | 8 |
| Nexans | 8 |
| Percon | 9 |
| Proel | 9 |
| RG | 9 |
| Sommer | 9 |
| Suhner | 10 |
| Tesca | 10 |
| Van Damme | 10 |
| Others | 10 |
| Connector to Cable Guide | 12 |
| rearTWIST HD & UHD | 12 |
| rearTWIST Tiny | 12 |
| Cable Jack Tiny & Panel Version | 13 |
| UHD BNC - Chassis | 14 |
| HD BNC Chassis | 15 |
| HD BNC.Cable Jack Panel Version | 16 |
| Technical Data | 17 |
| Accessories | 18 |
| General information: | |
| Definition, Abbreviation & Useful Information | 19 |
| Neutrik Part Number Guide | 20 |
| Neutrik Product Line | 21 |

BNC Connectors



NEUTRIK® 75 Ω BNC Connectors



Neutrik offers a variety of 75 Ω cable and chassis BNC connectors. The rearTWIST cable connectors are easy to handle in high density applications such as video patchbays and switches, provide a tactile and fast assembly and offer colour coding as a standard. All parts of our BNC series are precisely machined to our high quality standards.

rearTWIST® UHD – BNC Connector



With the transition to 4K or even 8K-signals the impedance of BNC connectors became more important than ever. Every deviate impedance has a negative influence on return loss and VSWR (Voltage Standing Wave Ratio) which are important measurements for reflected signals in a transmission line. Especially on high data rates up to 24 Gb/s, as they occur when transmitting ultra high definition (UHD) signals, an impedance mismatch results in high return loss.

Neutrik's new rearTWIST UHD-BNC connector is a specifically for high frequencies optimized BNC connector; based on the proven rearTWIST technology. The unique insulator design in combination with the reduced crimp diameter of the gold plated center pin allows UHD-data transmission within the required return loss limits.



Features & Benefits

- ① Screen and cable jacket crimp instead of screen crimp only. Grooved inner surface holds the cable jacket to prevent tearing braids.
- ② High frequency optimized insulator design for UHD-transmissions.
- ③ Reduced pin crimp diameter for performance improvement (return loss values).
- ④ Swiss antralooy plating
- ⑤ rearTWIST boot for easy access in high density applications.



Gold plated contacts



Precise Swiss machined parts

UHD 4K8K

rearTWIST UHD Connector



NBNC75BFG7X

- Optimized contact pin and insulator design for UHD-data transmissions
- Proven rearTWIST technology
- Swiss antralyo plating
- Fully compatible with conventional BNC chassis connectors
- Improved return loss values at high frequencies

Neutrik BNCs – Excellent return loss!

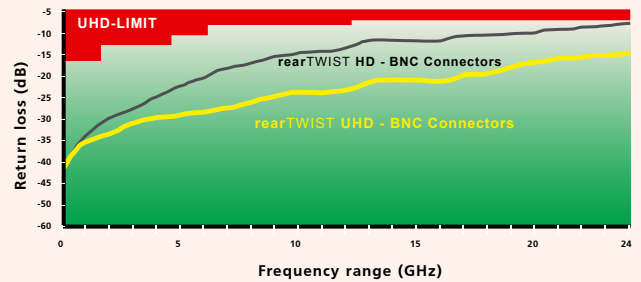

NBNC75*

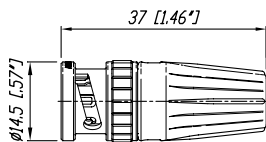



Bayonet locking



Gold plated contacts



9 different colors available

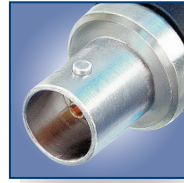

rearTWIST Female cable jack



r e a r T W I S T H D



NBNC75BFG7



NBNC75BLP7



NBNB75GLP9



NBTB75CFI4

- "rearTWIST Principle" locking / unlocking using the easily accessible soft touch boot (Patent DE 100 48507)
- Ideal for recessed bulkheads where access to the "head" of the connector might be an issue. These connectors turn from the back and not the front.
- Snug-fit center pin insert provides tactile feedback
- Shield and jacket crimp technology prevents the problem of an exposed grounding braid on cable assemblies
- Large version for RG 11 cable
- Precise Swiss machined brass parts for outstanding durability
- Accessories include color coded boots in 10 standard colors, crimp tool and dies
- Sleek female cable jack e.g. for Y-cables

NBNC75*

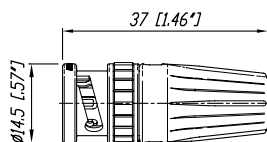

| | rearTWIST UHD | rearTWIST HD | rearTWIST HD Tiny | Cable Jack & Panel | Pin Crimp in mm | Hex Crimp in mm | Stripping Tool | | | |
|--|------------------|-----------------|----------------------|-----------------------|--------------------|--------------------|-------------------|------------|------------|--------------|
| | | | | | UHD | HD | CS-BNC-RT | CS-BNC-LCS | CS-BNC-LCV | + CS-BNC-TCI |

■ Argosy Image

| | | | | | | | | | | | |
|-------------------|--------------|-------------|--|-------------|------|-----|------|---|---|---|---|
| Argosy Image 360 | NBNC75BFG7X | NBNC75BFG7 | | | 1.07 | 1.6 | 5.00 | ● | - | - | - |
| Argosy Image 720 | NBNC75BLP9X | NBNC75BLP9 | | | 1.07 | 1.6 | 6.47 | ● | - | - | - |
| Argosy Image 1000 | NBNC75BUU11X | NBNC75BUU11 | | NBNB75GUU11 | 1.07 | 1.6 | 7.36 | ● | - | - | - |

■ Belden

| | | | | | | | | | | | |
|-----------------------------------|---------------|-------------|------------|-------------|------|-----|-------|---|---|---|---|
| Belden 1277R, 1278R, 1279R | | | NBTC75BNN5 | | | 1.6 | 4.53 | ● | - | - | ● |
| Belden 1406B, 1407B, 1417B | | | NBTC75BVV5 | | | 1.6 | 5.00 | ● | - | - | ● |
| Belden 1426A, 1505A (ANH), 4505R | NBNC75BLP9X | NBNC75BLP9 | | NBNB75GLP9 | 1.07 | 1.6 | 6.47 | ● | - | - | - |
| Belden 1505F | NBNC75BJP9X | NBNC75BJP9 | | | 1.07 | 1.6 | 6.47 | ● | - | - | - |
| Belden 1506A | | NBNC75BIJ9 | | | | 1.6 | 5.41 | ● | - | - | - |
| Belden 1520A, 1521A, 1522A, 179DT | | | NBTC75BFI4 | NBTB75CFI4 | | 1.6 | 4.06 | ● | - | - | ● |
| Belden 1694A (ANH, DNH) | NBNC75BTU11X | NBNC75BTU11 | | | 1.07 | 1.6 | 7.36 | ● | - | - | - |
| Belden 1694F | | NBNC75BRU11 | | | | 1.6 | 7.36 | ● | - | - | - |
| Belden 1695A | NBNC75BQP11X | NBNC75BQP11 | | | 1.07 | 1.6 | 6.47 | ● | - | - | - |
| Belden 1794A | | NBNC75BZV14 | | | | 1.6 | 8.23 | ● | - | - | - |
| Belden 1855A | NBNC75BDD6X | NBNC75BDD6 | | | 1.07 | 1.6 | 4.53 | ● | - | - | - |
| Belden 1855EFN | NBNC75BFG7X | NBNC75BFG7 | | | 1.07 | 1.6 | 5.00 | ● | - | - | - |
| Belden 1865A | | | NBTC75BXX6 | | | 1.6 | 5.00 | ● | - | - | ● |
| Belden 1855ENH | NBNC75BFG7X | NBNC75BFG7 | | | 1.07 | 1.6 | 5.00 | ● | - | - | - |
| Belden 4505P | | NBNC75BIJ9 | | | | 1.6 | 5.41 | ● | - | - | - |
| Belden 4505R | NBNC75BLP9X | NBNC75BLP9 | | | 1.07 | 1.6 | 6.47 | ● | - | - | - |
| Belden 4694P | NBNC75BQP11X | NBNC75BQP11 | | | 1.07 | 1.6 | 6.47 | ● | - | - | - |
| Belden 4694R | NBNC75BTU11X | NBNC75BTU11 | | | 1.07 | 1.6 | 7.36 | ● | - | - | - |
| Belden 4855P | NBNC75BDD6X | NBNC75BDD6 | | | 1.07 | 1.6 | 4.53 | ● | - | - | - |
| Belden 4855R | NBNC75BDD6X | NBNC75BDD6 | | | 1.07 | 1.6 | 4.53 | ● | - | - | ● |
| Belden 7731A (ANH) | | NBNC75BVZ17 | | | | 1.8 | 10.00 | - | - | ● | - |
| Belden 8218 | | | NBTC75BXX5 | | | 1.6 | 5.00 | ● | - | - | ● |
| Belden 8241 | NBNC75BLP7X | NBNC75BLP7 | | | 1.07 | 1.6 | 6.47 | ● | - | - | - |
| Belden 8241F | NBNC75BLP9X | NBNC75BLP9 | | NBNB75GLP9 | 1.07 | 1.6 | 6.47 | ● | - | - | - |
| Belden 8281 | | NBNC75BXY9 | | | | 1.6 | 8.23 | ● | - | - | - |
| Belden 8281F | | NBNC75BY9 | | | | 1.6 | 8.23 | ● | - | - | - |
| Belden 9221 | | | NBTC75BLI4 | | | 1.6 | 4.06 | ● | - | - | ● |
| Belden 70078CH HDTV | | | NBTC75BNN5 | NBTB75CINN5 | | 1.6 | 4.53 | ● | - | - | ● |
| Belden 70080, 70080NH | NBNC75BFG7X | NBNC75BFG7 | | | 1.07 | 1.6 | 5.00 | ● | - | - | - |
| Belden 70081, 70081NH | NBNC75BLP9X | NBNC75BLP9 | | | 1.07 | 1.6 | 6.47 | ● | - | - | - |
| Belden 70082, 70082CH & 70082NH | NBNC75BTU11X | NBNC75BTU11 | | | 1.07 | 1.6 | 7.36 | ● | - | - | - |
| | NBNC75BTUP11X | | | | 1.07 | | 7.06 | ● | - | - | - |

■ CAE

| | | | | | | | | | | | |
|-----------------|-------------|-------------|------------|------------|------|-----|-------|---|---|---|---|
| CAE MC75 | | | NBTC75BLI5 | NBTB75CLI5 | | 1.6 | 4.06 | ● | - | - | ● |
| CAE MC75.39 | | | NBTC75BVX6 | | | 1.6 | 5.00 | ● | - | - | ● |
| CAE KX6A | NBNC75BLP7X | NBNC75BLP7 | | | 1.07 | 1.6 | 6.47 | ● | - | - | - |
| CAE VCB75 | | NBNC75BNP9 | | | | 1.6 | 6.47 | ● | - | - | - |
| CAE VCB 100 | | NBNC75BXU13 | | | | 1.6 | 7.36 | ● | - | - | - |
| CAE HD1250FLEX | | NBNC75BXU13 | | | | 1.6 | 7.01 | ● | - | - | - |
| CAE HD10460LSZH | | NBNC75BTS11 | | | | 1.6 | 7.01 | ● | - | - | - |
| CAE HD0628LSZH | NBNC75BFG7X | NBNC75BFG7 | | | 1.07 | 1.6 | 5.00 | ● | - | - | - |
| CAE HD08370LSZH | NBNC75BLP9X | NBNC75BLP9 | | | 1.07 | 1.6 | 6.47 | ● | - | - | - |
| CAE HD16720LSZH | | NBNC75BVZ17 | | | | 1.8 | 10.00 | - | - | ● | - |



| | rearTWIST | rearTWIST | rearTWIST | Cable Jack & Panel | Pin Crimp | | Hex Crimp | Stripping | | | | | | |
|--|-----------|-----------|-----------|-----------------------|-----------|-------|-----------|-----------|------------|------------|--------------|--|--|--|
| | UHD | HD | HD Tiny | | in mm | in mm | in mm | Tool | | | | | | |
| | | | | | UHD | HD | | CS-BNC-RT | CS-BNC-LCS | CS-BNC-LCV | + CS-BNC-TCI | | | |

■ Canare

| | | | | | | | | | | | | | | |
|----------------------------|--------------|-------------|------------|------------|------|-----|------|------|---|---|---|---|--|--|
| Canare L-2.5CHWS | NBNC75BFG7X | NBNC75BFG7 | | | 1.07 | 1.6 | 5.00 | ● | - | - | - | | | |
| Canare L-3CFB, L-3C2VS | | NBNC75BHK7 | | | | | 1.6 | 5.41 | ● | - | - | - | | |
| Canare L-3.3CUHD | NBNC75BLP9X | NBNC75BLP9 | | | 1.07 | 1.6 | 6.47 | ● | - | - | - | | | |
| Canare L-4CFB | NBNC75BLP9X | NBNC75BLP9 | | NBNB75GLP9 | 1.07 | 1.6 | 6.47 | ● | - | - | - | | | |
| Canare L-4.5CHD, L-4.5CHWS | NBNC75BTU11X | NBNC75BTU11 | | | 1.07 | 1.6 | 7.36 | ● | - | - | - | | | |
| Canare L-5CFB | | NBNC75BYY11 | | | | | 1.6 | 8.23 | ● | - | - | - | | |
| Canare L-5.5 CUHD | NBNC75BZV14X | | | | | | 1.6 | 8.23 | - | ● | - | - | | |
| Canare LV-61S | NBNC75BLP7X | NBNC75BLP7 | | | 1.07 | 1.6 | 6.47 | ● | - | - | - | | | |
| Canare LV-77S | | NBNC75BYY9 | | | | | 1.6 | 8.23 | ● | - | - | - | | |
| Canare V(3-5)-3C | | NBNC75BGG7 | | | | | 1.6 | 5.00 | ● | - | - | - | | |
| Canare V(3-5)-4CFB | | NBNC75BJJ9 | | | | | 1.6 | 5.41 | ● | - | - | - | | |
| Canare V(3-5)-5C | | NBNC75BRS9 | | | | | 1.6 | 7.01 | ● | - | - | - | | |
| Canare V(3-5)-5CFB | | NBNC75BWS11 | | | | | 1.6 | 7.01 | ● | - | - | - | | |
| Canare L-1.5C2VS | | | NBTC75BLI4 | | | | 1.6 | 4.06 | ● | - | - | ● | | |
| Canare L-3CFW | NBNC75BLP7X | NBNC75BLP7 | | | 1.07 | 1.6 | 6.47 | ● | - | - | - | | | |
| Canare L-5CFW | | NBNC75BYY11 | | | | | 1.6 | 8.23 | ● | - | - | - | | |

■ Canford

| | | | | | | | | | | | | | | |
|--------------------------|--------------|-------------|--|--|------|-----|------|-------|---|---|---|---|--|--|
| Canford SDV, SDV-X, SDM | NBNC75BFG7X | NBNC75BFG7 | | | 1.07 | 1.6 | 5.00 | ● | - | - | - | | | |
| Canford SDV-F, SDV-XF | | NBNC75BUU11 | | | | | 1.6 | 7.36 | ● | - | - | - | | |
| Canford SDV-F-HD | | NBNC75BWU13 | | | | | 1.6 | 7.36 | ● | - | - | - | | |
| Canford SDV-HD | | NBLC75BVZ17 | | | | | 1.8 | 10.00 | - | - | ● | - | | |
| Canford SDV-I-X-LFH | NBNC75BLP9X | NBNC75BLP9 | | | 1.07 | 1.6 | 6.47 | ● | - | - | - | | | |
| Canford SDV-L, SDV-F | NBNC75BUU11X | NBNC75BUU11 | | | | | 1.6 | 7.01 | ● | - | - | - | | |
| Canford SDV-M | | NBTB75CNN5 | | | | | 1.6 | 4.53 | ● | - | - | ● | | |
| Canford VCS (BBC PSF1/3) | | NBNC75BLS7 | | | | | 1.6 | 7.01 | ● | - | - | - | | |

■ Clark

| | | | | | | | | | | | | | | |
|---------------------------|--------------|-------------|--|--|------|-----|------|------|---|---|---|---|--|--|
| Clark CD7559-0, CD7559F-0 | NBNC75BLP9X | NBNC75BLP9 | | | 1.07 | 1.6 | 6.47 | ● | - | - | - | | | |
| Clark CD7523-7 | NBNC75BDD6X | NBNC75BDD6 | | | 1.07 | 1.6 | 4.53 | ● | - | - | ● | | | |
| Clark CD7506-0 | NBNC75BTU11X | NBNC75BTU11 | | | 1.07 | 1.6 | 7.36 | ● | - | - | - | | | |
| Clark CD7506F-0 | | NBNC75BRU11 | | | | | 1.6 | 7.36 | ● | - | - | - | | |

■ Commscope

| | | | | | | | | | | | | | | |
|------------------------|--------------|-------------|------------|------------|------|-----|------|------|---|---|---|---|--|--|
| Commscope 2065V | | NBNC75BIJ9 | | | | | 1.6 | 5.41 | ● | - | - | - | | |
| Commscope 2279V | | NBNC75BQP11 | | | | | 1.6 | 6.47 | ● | - | - | - | | |
| Commscope 5563 | NBNC75BLP7X | NBNC75BLP7 | | | 1.07 | 1.6 | 6.47 | ● | - | - | - | | | |
| Commscope 5565 | NBNC75BLP9X | NBNC75BLP9 | | NBNB75GLP9 | 1.07 | 1.6 | 6.47 | ● | - | - | - | | | |
| Commscope 5765 | NBNC75BTU11X | NBNC75BTU11 | | | 1.07 | 1.6 | 7.36 | ● | - | - | - | | | |
| Commscope 7536 (03-05) | | | NBTC75BXX6 | | | | 1.6 | 5.00 | ● | - | - | ● | | |
| Commscope 7538 | NBNC75BDD6X | NBNC75BDD6 | | | 1.07 | 1.6 | 4.53 | ● | - | - | - | | | |

■ Cordial

| | | | | | | | | | | | | | | |
|---------------------------------------|--------------|-------------|--|--|------|-----|------|------|---|---|---|---|--|--|
| Cordial CVI 3-7 | NBNC75BFG7X | NBNC75BFG7 | | | 1.07 | 1.6 | 4.53 | ● | - | - | - | | | |
| Cordial CVI 06-28 | NBNC75BFG7X | NBNC75BFG7 | | | 1.07 | 1.6 | 5.00 | ● | - | - | - | | | |
| Cordial CVI 06-28HD, CVI 06-28HD-FRNC | NBNC75BFG7X | NBNC75BFG7 | | | 1.07 | 1.6 | 5.00 | ● | - | - | - | | | |
| Cordial CVI (CVM) 06-37 | NBNC75BLP7X | NBNC75BLP7 | | | 1.07 | 1.6 | 6.47 | ● | - | - | - | | | |
| Cordial CVI 08-37 HD-FRNC | | NBNC75BNP9 | | | | | 1.6 | 6.47 | ● | - | - | - | | |
| Cordial CVI 10-48 HD | NBNC75BUU11X | NBNC75BUU11 | | | 1.07 | 1.6 | 7.36 | ● | - | - | - | | | |

| | rearTWIST UHD | rearTWIST HD | rearTWIST HD Tiny | Cable Jack & Panel | Pin Crimp in mm | | Hex Crimp in mm | Stripping Tool | | | |
|----------------------------|---------------|--------------|-------------------|--------------------|-----------------|-----|-----------------|----------------|------------|------------|--------------|
| | | | | | UHD | HD | | CS-BNC-RT | CS-BNC-LCS | CS-BNC-LCV | + CS-BNC-TCI |
| Cordial CVI 10-48 HD-FRNC | | NBNC75BWS11 | | | | 1.6 | 7.01 | ● | - | - | - |
| Cordial CVM 08-32 HD-FLEX | | NBNC75BIJ9 | | | | 1.6 | 5.41 | ● | - | - | - |
| Cordial CVM 08-37 UHD-FLEX | NBNC75BJP9X | NBNC75BJP9 | | | 1.07 | 1.6 | 6.47 | ● | - | - | - |
| Cordial CVM 12-50 HD-FLEX | | NBNC75BWU13 | | | | 1.6 | 7.36 | ● | - | - | - |
| Cordial CVM 12-50 UHD-FLEX | | NBNC75BWU13 | | | | 1.6 | 7.36 | ● | - | - | - |

■ Draka Multimedia Cable

| | | | | | | | | | | | |
|---|--------------|-------------|------------|-------------|------|------|-------|---|---|---|---|
| 0.31 / 1.45 AF, 753-1304(2), 755-1302 | | | NBTC75BFI4 | NBTB75CFI4 | | 1.6 | 4.06 | ● | - | - | ● |
| 0.41 / 1.9 AF, 753-1104, 755-1103, 755-1101 | | | NBTC75BNN5 | NBTB75CNN5 | | 1.6 | 4.53 | ● | - | - | ● |
| 0.51 / 2.3 Dz, 757-1001, VADN 7243 | | | NBTC75BVX6 | | | 1.6 | 5.00 | ● | - | - | ● |
| 0.6 / 2.8 AF, 0.6 L / 2.8 AF | NBNC75BFG7X | NBNC75BFG7 | | | 1.07 | 1.6 | 5.00 | ● | - | - | - |
| HD Pro 0.6/2.8 AF | NBNC75BFG7X | NBNC75BFG7 | | | 1.07 | 1.6 | 5.00 | ● | - | - | - |
| 0.6 / 3.7, 0.6L / 3.7 | NBNC75BLP7X | NBNC75BLP7 | | | 1.07 | 1.6 | 6.47 | ● | - | - | - |
| 0.6 / 3.7 Dz | | NBNC75BLS7 | | | | 1.6 | 7.01 | ● | - | - | - |
| 0.8 / 3.7 AF, 755-801(803, 804) | NBNC75BLP9X | NBNC75BLP9 | | NBNB75GLP9 | 1.07 | 1.6 | 6.47 | ● | - | - | - |
| Highflex 08L/3.7D, HD Pro 0.8/3.7 AF | NBNC75BLP9X | NBNC75BLP9 | | | 1.07 | 1.6 | 6.47 | ● | - | - | - |
| 0.8 / 4.9 Dz | | NBNC75BXY9 | | | | 1.6 | 8.23 | ● | - | - | - |
| 1.0 / 4.8 AF, 755-901/5 | NBNC75BUU11X | NBNC75BUU11 | | NBNB75GUU11 | 1.07 | 1.6 | 7.36 | ● | - | - | - |
| 1.2L / 4.8Dz, 1.2L / 4.95AF | | NBNC75BWU13 | | | | 1.6 | 7.36 | ● | - | - | - |
| 1.4 / 6.6 AF | | NBLC75BSX14 | | | | 1.75 | 9.73 | - | ● | - | - |
| 1.6 / 7.3AF | | NBLC75BVZ17 | | | | 1.8 | 10.00 | - | - | ● | - |
| Ultra HD PRO50 UHD | NBNC75BFG7X | NBNC75BFG7 | | | 1.07 | 1.6 | 5.00 | ● | - | - | - |

■ Direct Cable

| | | | | | | | | | | | |
|----------------------|--------------|-------------|--|--|------|-----|------|---|---|---|---|
| Direct Cable 301-299 | NBNC75BLP9X | NBNC75BLP9 | | | 1.07 | 1.6 | 6.47 | ● | - | - | - |
| Direct Cable 301-330 | NBNC75BTU11X | NBNC75BTU11 | | | 1.07 | 1.6 | 7.36 | ● | - | - | - |
| Direct Cable 301-340 | | NBNC75BRU11 | | | | 1.6 | 7.60 | ● | - | - | - |
| Direct Cable 301-351 | NBNC75BFG7X | NBNC75BFG7 | | | 1.07 | 1.6 | 5.00 | ● | - | - | - |
| Direct Cable 301-361 | NBNC75BTU11X | NBNC75BTU11 | | | 1.07 | 1.6 | 7.36 | ● | - | - | - |
| Direct Cable 360-036 | NBNC75BFG7X | NBNC75BFG7 | | | 1.07 | 1.6 | 5.00 | ● | - | - | - |
| Direct Cable 360-031 | NBNC75BFG7X | NBNC75BFG7 | | | 1.07 | 1.6 | 5.00 | ● | - | - | - |

■ Kabeltronik

| | | | | | | | | | | | |
|------------------------------------|-------------|-------------|--|--|------|-----|------|---|---|---|---|
| Kabeltronik HFV 1.0/4.8 AF-FRNC | | NBNC75BRU11 | | | | 1.6 | 7.36 | ● | - | - | - |
| Kabeltronik HFV 0.6/2.8 AF-FRNC | NBNC75BFG7X | NBNC75BFG7 | | | 1.07 | 1.6 | 5.00 | ● | - | - | - |
| Kabeltronik MVP 5x 0.6/2.8 AF-FRNC | NBNC75BFG7X | NBNC75BFG7 | | | 1.07 | 1.6 | 5.00 | ● | - | - | - |

■ KLOTZ

| | | | | | | | | | | | |
|-------------------------------|--------------|-------------|--|-------------|------|-----|-------|---|---|---|---|
| KLOTZ V06/28, V062SH, VMXx75Y | NBNC75BFG7X | NBNC75BFG7 | | | 1.07 | 1.6 | 5.00 | ● | - | - | - |
| KLOTZ V06/37 | NBNC75BLP7X | NBNC75BLP7 | | | 1.07 | 1.6 | 6.47 | ● | - | - | - |
| KLOTZ V08/37H, VD083SH | NBNC75BLP9X | NBNC75BLP9 | | | 1.07 | 1.6 | 6.47 | ● | - | - | - |
| KLOTZ V10/48, V10/48H | NBNC75BUU11X | NBNC75BUU11 | | NBNB75GUU11 | 1.07 | 1.6 | 7.36 | ● | - | - | - |
| KLOTZ V16/72 | | NBLC75BVZ17 | | | | 1.8 | 10.00 | - | - | ● | - |
| KLOTZ VD083LP 0.8L/3.7DZ | NBNC75BJP9X | NBNC75BJP9 | | | 1.07 | 1.6 | 6.47 | ● | - | - | - |
| KLOTZ VD125LPS | | NBNC75BWU13 | | | | 1.6 | 7.36 | ● | - | - | - |
| KLOTZ VD167SH-E | | NBLC75BVZ17 | | | | 1.8 | 10.00 | - | - | ● | - |

| | rearTWIST UHD | rearTWIST HD | rearTWIST HD Tiny | Cable Jack & Panel | Pin Crimp in mm | | Hex Crimp in mm | Stripping Tool | | | | | | | |
|--|------------------|-----------------|----------------------|-----------------------|--------------------|----|--------------------|-------------------|------------|------------|--------------|--|--|--|--|
| | | | | | UHD | HD | | CS-BNC-RT | CS-BNC-LCS | CS-BNC-LCV | + CS-BNC-TCI | | | | |

■ Nexans

| | | | | | | | | | | | | | | | |
|------------------------------------|-------------|-------------|--|--|------|-----|------|-------|---|---|---|---|--|--|--|
| Nexans HF 75 0.6/2.9 02YS(ST)CH | NBNC75BFG7X | NBNC75BFG7 | | | 1.07 | 1.6 | 5.00 | ● | - | - | - | | | | |
| Nexans HF 75 1.6/7.2 02Y(ST)C(ST)H | | NBNC75BVZ17 | | | | | 1.8 | 10.00 | - | - | ● | - | | | |
| Nexans HF 75 0.6/3.7 2YCY | NBNC75BLP7X | NBNC75BLP7 | | | 1.07 | 1.6 | 6.47 | ● | - | - | - | | | | |

■ Percon

| | | | | | | | | | | | | | | | |
|-----------------|--------------|-------------|------------|--|------|------|------|---|---|---|---|--|--|--|--|
| Percon VK2 | | | NBTC75BNN5 | | | 1.6 | 4.53 | ● | - | - | ● | | | | |
| Percon VK5 | NBNC75BFG7X | NBNC75BFG7 | | | 1.07 | 1.6 | 5.00 | ● | - | - | - | | | | |
| Percon VK6 | NBNC75BLP9X | NBNC75BLP9 | | | 1.07 | 1.6 | 6.47 | ● | - | - | - | | | | |
| Percon VK66 ENH | NBNC75BJP9X | NBNC75BJP9 | | | 1.07 | 1.6 | 6.47 | ● | - | - | - | | | | |
| Percon VK7 | NBNC75BUU11X | NBNC75BUU11 | | | 1.07 | 1.6 | 7.36 | ● | - | - | - | | | | |
| Percon VK77 | NBNC75BTU11X | NBNC75BTU11 | | | 1.07 | 1.6 | 7.36 | ● | - | - | - | | | | |
| Percon VK770F | | NBNC75BWU13 | | | | 1.6 | 7.36 | ● | - | - | - | | | | |
| Percon VK8 | | NBLC75BSX14 | | | | 1.75 | 9.73 | - | ● | - | - | | | | |
| Percon VK9 | | NBLC75BVZ17 | | | | 1.8 | 10.0 | - | - | ● | - | | | | |
| Percon VK95 | NBNC75BLP7X | NBNC75BLP7 | | | 1.07 | 1.6 | 6.47 | ● | - | - | - | | | | |

■ Proel

| | | | | | | | | | | | | | | | |
|---------------|-------------|------------|--|--|------|-----|------|---|---|---|---|--|--|--|--|
| Proel HPC 805 | NBNC75BLP7X | NBNC75BLP7 | | | 1.07 | 1.6 | 6.47 | ● | - | - | - | | | | |
| Proel HPC 810 | NBNC75BLP9X | NBNC75BLP9 | | | 1.07 | 1.6 | 6.47 | ● | - | - | - | | | | |
| Proel HPC 820 | | NBNC75BFH6 | | | | 1.6 | 5.00 | ● | - | - | - | | | | |

■ RG

| | | | | | | | | | | | | | | | |
|----------|-------------|-------------|------------|--|------|-----|-------|---|---|---|---|--|--|--|--|
| RG11 | | NBLC75BVZ17 | | | | 1.8 | 10.00 | - | - | ● | - | | | | |
| RG59B/U | NBNC75BLP7X | NBNC75BLP7 | | | 1.07 | 1.6 | 6.47 | ● | - | - | - | | | | |
| RG179B/U | | | NBTC75BLI4 | | | 1.6 | 4.06 | ● | - | - | ● | | | | |

■ SOMMER

| | | | | | | | | | | | | | | | |
|----------------------------------|--------------|-------------|------------|------------|------|------|-------|---|---|---|---|--|--|--|--|
| SOMMER 600-0041C | | | NBTC75NBS4 | | | 1.6 | 4.53 | ● | - | - | - | | | | |
| SOMMER 600-0051 (M/L/S) | NBNC75BLP7X | NBNC75BLP7 | | | 1.07 | 1.6 | 6.47 | ● | - | - | - | | | | |
| SOMMER 600-0054 (M/L/S) | NBNC75BLP7X | NBNC75BLP7 | | | 1.07 | 1.6 | 6.47 | ● | - | - | - | | | | |
| SOMMER 600-0101M | NBNC75BFG7X | NBNC75BFG7 | | | 1.07 | 1.6 | 5.00 | ● | - | - | - | | | | |
| SOMMER 600-0104M | NBNC75BFG7X | NBNC75BFG7 | | | 1.07 | 1.6 | 5.00 | ● | - | - | - | | | | |
| SOMMER 600-0131 | | NBLC75BSX14 | | | | 1.75 | 9.73 | - | ● | - | - | | | | |
| SOMMER 600-0144 | NBNC75BUU11X | NBNC75BUU11 | | | 1.07 | 1.6 | 7.36 | ● | - | - | - | | | | |
| SOMMER 600-162(F), Vctor 0.8/3.7 | NBNC75BLP9X | NBNC75BLP9 | | | 1.07 | 1.6 | 6.47 | ● | - | - | - | | | | |
| SOMMER 600-0174 | | NBNC75BWU13 | | | | 1.6 | 7.36 | ● | - | - | - | | | | |
| SOMMER 600-0174FC | | NBNC75BWU13 | | | | 1.6 | 7.36 | ● | - | - | - | | | | |
| SOMMER 600-0214 | | NBNC75BWU13 | | | | 1.6 | 7.36 | ● | - | - | - | | | | |
| SOMMER 600-025* -03 (05) | | | NBTC75BLI5 | NBTB75CLI5 | | 1.6 | 4.06 | ● | - | - | ● | | | | |
| SOMMER 600-0701 | | | NBTC75BLI5 | NBTB75CLI5 | | 1.6 | 4.06 | ● | - | - | ● | | | | |
| SOMMER 600-020* -03 (05) | | | NBTC75BLI5 | NBTB75CLI5 | | 1.6 | 4.06 | ● | - | - | ● | | | | |
| SOMMER 600-0234 | | NBLC75BVZ17 | | | | 1.8 | 10.00 | - | - | ● | - | | | | |
| SOMMER 600-0234FC | | NBLC75BVZ17 | | | | 1.8 | 10.00 | - | - | ● | - | | | | |
| SOMMER 600-0451 | NBNC75BLP9X | NBNC75BLP9 | | NBNB75GLP9 | 1.07 | 1.6 | 6.47 | ● | - | - | - | | | | |
| SOMMER 600-0621-05 | NBNC75BFG7X | NBNC75BFG7 | | | 1.07 | 1.6 | 5.00 | ● | - | - | - | | | | |
| SOMMER 600-0751 | | | NBTC75BVX6 | | | 1.6 | 5.00 | ● | - | - | ● | | | | |
| SOMMER 600-0791 | NBNC75BFG7X | NBNC75BFG7 | | | 1.07 | 1.6 | 5.00 | ● | - | - | - | | | | |
| SOMMER 600-0851 | NBNC75BFG7X | NBNC75BFG7 | | | 1.07 | 1.6 | 5.00 | ● | - | - | - | | | | |
| SOMMER 600-0851-05 | NBNC75BFG7X | NBNC75BFG7 | | | 1.07 | 1.6 | 5.00 | ● | - | - | - | | | | |

| | rearTWIST | rearTWIST | rearTWIST | Cable Jack & Panel | Pin Crimp | | Hex Crimp | | Stripping Tool | | | |
|-----------------------|--------------|-------------|------------|-----------------------|-----------|------|-----------|---|-------------------|------------|------------|--------------|
| | UHD | HD | HD Tiny | | UHD | HD | | | CS-BNC-RT | CS-BNC-LCS | CS-BNC-LCV | + CS-BNC-TCI |
| SOMMER 600-1031 | | NBNC75BWU13 | | | | 1.6 | 7.36 | ● | - | - | - | |
| SOMMER 600-1451 | NBNC75BFG7X | NBNC75BFG7 | | | 1.07 | 1.6 | 5.00 | ● | - | - | - | |
| -SOMMER 600-2001 | | NBNC75BWU13 | | | | 1.6 | 7.36 | ● | - | - | - | |
| SOMMER 600-2031 | | NBNC75BWU13 | | | | 1.6 | 7.36 | ● | - | - | - | |
| SOMMER 600-2101 | NBNC75BFG7X | NBNC75BFG7 | | | 1.07 | 1.6 | 5.00 | ● | - | - | - | |
| SOMMER 600-2231 | NBNC75BLP9X | NBNC75BLP9 | | | 1.07 | 1.6 | 6.47 | ● | - | - | - | |
| SOMMER 600-2781 | | NBNC75BWU13 | | | | 1.6 | 7.36 | ● | - | - | - | |
| SOMMER 600-2791 | | NBNC75BWU13 | | | | 1.6 | 7.36 | ● | - | - | - | |
| SOMMER 600-2811-01 | | NBNC75BWU13 | | | | 1.6 | 7.36 | ● | - | - | - | |
| SOMMER 600-3202 | | NBNC75BWU13 | | | | 1.6 | 7.36 | ● | - | - | - | |
| SOMMER 605-0761 | NBNC75BFG7X | NBNC75BFG7 | | | 1.07 | 1.6 | 5.00 | ● | - | - | - | |
| ■ Suhner | | | | | | | | | | | | |
| Suhner G02233 | | | NBTC75BFI4 | NBTB75CFI4 | | 1.6 | 4.06 | ● | - | - | ● | |
| Suhner G04233D | | NBNC75BLS7 | | | | 1.6 | 7.01 | ● | - | - | - | |
| Suhner S02223 | | | NBTC75BLI4 | | | 1.6 | 4.06 | ● | - | - | ● | |
| Suhner S04233, S04263 | NBNC75BLP9X | NBNC75BLP9 | | NBNB75GLP9 | 1.07 | 1.6 | 6.47 | ● | - | - | - | |
| Suhner S05133-07 | NBNC75BTU11X | NBNC75BTU11 | | | 1.07 | 1.6 | 7.36 | ● | - | - | - | |
| Suhner S05163-02 | NBNC75BTU11X | NBNC75BTU11 | | | 1.07 | 1.6 | 7.36 | ● | - | - | - | |
| ■ Tesca | | | | | | | | | | | | |
| Tesca Bachelor | | NBNC75BWU13 | | | | 1.6 | 7.36 | ● | - | - | - | |
| Tesca Bachelor PUR | | NBNC75BZV14 | | | | 1.6 | 8.23 | - | ● | - | - | |
| Tesca Bengal | | | NBTC75BNS4 | | | 1.6 | 4.53 | ● | - | - | ● | |
| Tesca DUBLO V | | NBNC75BWU13 | | | | 1.6 | 7.36 | ● | - | - | - | |
| Tesca Fabio 12G | | NBNC75BUU11 | | | | 1.6 | 7.36 | ● | - | - | - | |
| Tesca KXV6 | | NBNC75BLP7 | | | | 1.6 | 6.47 | ● | - | - | - | |
| Tesca Supra | NBNC75BFG7X | NBNC75BFG7 | | | 1.07 | 1.6 | 5.00 | ● | - | - | - | |
| Tesca Massimo | | NBLC75BSX14 | | | | 1.75 | 9.73 | - | ● | - | - | |
| Tesca Sphere | | NBLC75BVZ17 | | | | 1.8 | 10.00 | - | - | ● | - | |
| Tesca Presto | | NBNC75BJP9 | | | | 1.6 | 6.47 | ● | - | - | - | |
| Tesca Prima | | NBNC75BTS11 | | | | 1.6 | 7.01 | ● | - | - | - | |
| Tesca Linea | | NBNC75BNP9 | | | | 1.6 | 6.47 | ● | - | - | - | |
| Tesca Vostok | | NBNC75BWS12 | | | | 1.6 | 7.01 | ● | - | - | - | |
| Tesca Dublo | | NBNC75BWS12 | | | | 1.6 | 7.01 | ● | - | - | - | |
| ■ Van Damme | | | | | | | | | | | | |
| Van Damme 268-175-000 | NBNC75BUU11X | NBNC75BUU11 | | | 1.07 | 1.6 | 7.36 | ● | - | - | - | |
| Van Damme 268-275-000 | NBNC75BJP9X | NBNC75BJP9 | | | 1.07 | 1.6 | 6.47 | ● | - | - | - | |
| Van Damme 268-306-000 | NBNC75BLP9X | NBNC75BLP9 | | | 1.07 | 1.6 | 6.47 | ● | - | - | - | |
| Van Damme 268-408-000 | | | NBTC75BFI4 | | | 1.6 | 6.47 | ● | - | - | ● | |
| Van Damme 268-475-000 | NBNC75BTU11X | NBNC75BTU11 | | | 1.07 | 1.6 | 7.36 | ● | - | - | - | |
| Van Damme 268-675-000 | NBNC75BTU11X | NBNC75BTU11 | | | 1.07 | 1.6 | 7.36 | ● | - | - | - | |
| Van Damme 278-475-000 | | NBLC75BVZ17 | | | | 1.8 | 10.00 | - | - | ● | - | |
| Van Damme 278-175-000 | NBNC75BUU11X | NBNC75BUU11 | | | 1.07 | 1.6 | 7.36 | ● | - | - | - | |
| Van Damme 278-975-000 | NBNC75BLP9X | NBNC75BLP9 | | | 1.07 | 1.6 | 6.47 | ● | - | - | - | |
| Van Damme 278-775-000 | | | NBTC75BSS5 | | | 1.6 | 4.53 | ● | - | - | ● | |
| Van Damme 278-075-000 | NBNC75BFG7X | NBNC75BFG7 | | | 1.07 | 1.6 | 5.00 | ● | - | - | - | |
| Van Damme 278-075-006 | NBNC75BFG7X | NBNC75BFG7 | | | 1.07 | 1.6 | 5.00 | ● | - | - | - | |
| Van Damme 278-375-000 | NBNC75BUU11X | NBNC75BUU11 | | | 1.07 | 1.6 | 7.36 | ● | - | - | - | |

| | Inner Conductor | Insulator | Cable O.D. mm | Pin crimp mm (square) | Hex Crimp mm | Stripping Tool | | | |
|--|-----------------|-----------|---------------|-----------------------|--------------|----------------|------------|------------|--------------|
| | | | | | | CS-BNC-RT | CS-BNC-LCS | CS-BNC-LCV | + CS-BNC-TCI |

rearTWIST HD & UHD

| | | | | | | | | | |
|---------------|-------|-------|--------|-------------------|-------|---|---|---|---|
| NBLC75BVZ17 | < 1.7 | < 8.0 | < 10.4 | 1.80 (Hex crimp) | 10.00 | - | - | ● | - |
| NBLC75BSX14 | < 1.4 | < 6.6 | < 9.5 | 1.75 (Hex crimp) | 9.73 | - | ● | - | - |
| NBNC75BDD6 | < 0.6 | < 2.8 | < 4.3 | 1.6 | 4.53 | ● | - | - | - |
| NBNC75BDD6X | < 0.6 | < 2.8 | < 4.3 | 1.07 | 4.53 | ● | - | - | - |
| NBNC75BFG7 | < 0.7 | < 3.1 | < 4.7 | 1.6 | 5.00 | ● | - | - | - |
| NBNC75BFG7X | < 0.7 | < 3.1 | < 4.7 | 1.07 | 5.00 | ● | - | - | - |
| NBNC75BFH6 | < 0.6 | < 3.1 | < 4.9 | 1.6 | 5.00 | ● | - | - | - |
| NBNC75BGG7 | < 0.7 | < 3.2 | < 4.7 | 1.6 | 5.00 | ● | - | - | - |
| NBNC75BHK7 | < 0.7 | < 3.3 | < 5.6 | 1.6 (or 1.75 Hex) | 5.41 | ● | - | - | - |
| NBNC75BIJ9 | < 0.9 | < 3.6 | < 5.3 | 1.6 | 5.41 | ● | - | - | - |
| NBNC75BIJ9 | < 0.9 | < 3.8 | < 5.3 | 1.6 | 5.41 | ● | - | - | - |
| NBNC75BJP9 | < 0.9 | < 3.8 | < 6.3 | 1.6 | 6.47 | ● | - | - | - |
| NBNC75BJP9X | < 0.9 | < 3.8 | < 6.3 | 1.07 | 6.47 | ● | - | - | - |
| NBNC75BLP7 | < 0.7 | < 3.8 | < 6.3 | 1.6 | 6.47 | ● | - | - | - |
| NBNC75BLP7X | < 0.7 | < 3.8 | < 6.3 | 1.07 | 6.47 | ● | - | - | - |
| NBNC75BLP9 | < 0.9 | < 3.8 | < 6.3 | 1.6 | 6.47 | ● | - | - | - |
| NBNC75BLP9X | < 0.9 | < 3.8 | < 6.3 | 1.07 | 6.47 | ● | - | - | - |
| NBNC75BLS7 | < 0.7 | < 3.8 | < 6.9 | 1.6 | 7.01 | ● | - | - | - |
| NBNC75BNP9 | < 0.9 | < 4.1 | < 6.3 | 1.6 | 6.47 | ● | - | - | - |
| NBNC75BQP11 | < 1.1 | < 4.5 | < 6.3 | 1.6 | 6.47 | ● | - | - | - |
| NBNC75BQP11X | < 1.1 | < 4.5 | < 6.3 | 1.07 | 6.47 | ● | - | - | - |
| NBNC75BRS9 | < 0.9 | < 4.8 | < 6.9 | 1.6 | 7.01 | ● | - | - | - |
| NBNC75BTS9 | < 0.9 | < 4.7 | < 6.9 | 1.6 | 7.01 | ● | - | - | - |
| NBNC75BTS11 | < 1.1 | < 4.7 | < 6.9 | 1.6 | 7.01 | ● | - | - | - |
| NBNC75BTU11 | < 1.1 | < 4.7 | < 7.3 | 1.6 | 7.36 | ● | - | - | - |
| NBNC75BTU11X | < 1.1 | < 4.7 | < 7.3 | 1.07 | 7.36 | ● | - | - | - |
| NBNC75BTUP11X | < 1.1 | < 4.7 | < 7.3 | 1.07 | 7.06 | ● | - | - | - |
| NBNC75BTU13 | < 1.4 | < 4.7 | < 7.3 | 1.6 | 7.36 | ● | - | - | - |
| NBNC75BUU11 | < 1.1 | < 4.9 | < 7.3 | 1.6 | 7.36 | ● | - | - | - |
| NBNC75BUU11X | < 1.1 | < 4.9 | < 7.3 | 1.07 | 7.36 | ● | - | - | - |
| NBNC75BRU11 | < 1.1 | < 4.8 | < 7.3 | 1.6 | 7.36 | ● | - | - | - |
| NBNC75BWS11 | < 1.1 | < 5.1 | < 6.9 | 1.6 | 7.01 | ● | - | - | - |
| NBNC75BWS12 | < 1.2 | < 5.1 | < 6.9 | 1.6 | 7.01 | ● | - | - | - |
| NBNC75BWU13 | < 1.4 | < 5.1 | < 7.3 | 1.6 | 7.36 | ● | - | - | - |
| NBNC75BXU13 | < 1.4 | < 5.3 | < 7.3 | 1.6 | 7.36 | ● | - | - | - |
| NBNC75BXY9 | < 0.9 | < 5.3 | < 8.0 | 1.6 | 8.23 | ● | - | - | - |
| NBNC75BYY9 | < 0.9 | < 5.2 | < 8.0 | 1.6 | 8.23 | ● | - | - | - |
| NBNC75BYY11 | < 1.1 | < 5.2 | < 8.0 | 1.6 | 8.23 | ● | - | - | - |
| NBNC75BZV14 | < 1.4 | < 5.2 | < 8.2 | 1.6 (or 1.75 Hex) | 8.23 | ● | - | - | - |
| NBNC75BZV14X | < 1.4 | < 5.2 | < 8.2 | 1.6 (or 1.75 Hex) | 8.23 | ● | - | - | - |
| NBNC75BXU13X | < 1.4 | < 5.3 | < 7.3 | 1.6 | 7.36 | ● | - | - | - |

rearTWIST TINY

| | | | | | | | | | |
|------------|-------|-------|-------|-----|------|---|---|---|---|
| NBTC75BFI4 | < 0.4 | < 1.6 | < 2.9 | 1.6 | 4.06 | ● | - | - | ● |
| NBTC75BLI4 | < 0.4 | < 1.8 | < 2.9 | 1.6 | 4.06 | ● | - | - | ● |
| NBTC75BLI5 | < 0.5 | < 1.8 | < 2.9 | 1.6 | 4.06 | ● | - | - | ● |
| NBTC75BNN5 | < 0.5 | < 2.0 | < 3.1 | 1.6 | 4.53 | ● | - | - | ● |
| NBTC75BNS4 | < 0.4 | < 2.0 | < 3.5 | 1.6 | 4.53 | ● | - | - | ● |
| NBTC75BSS5 | < 0.5 | < 2.3 | < 3.4 | 1.6 | 4.53 | ● | - | - | ● |
| NBTC75BVV5 | < 0.5 | < 2.5 | < 3.8 | 1.6 | 5.00 | ● | - | - | ● |
| NBTC75BVX6 | < 0.6 | < 2.5 | < 4.0 | 1.6 | 5.00 | ● | - | - | ● |
| NBTC75BXX5 | < 0.5 | < 2.6 | < 4.0 | 1.6 | 5.00 | ● | - | - | ● |



D-shape metal housing



Gold plated center pin



UHD BNC Chassis



NBB75DFGX

- Optimized gold plated cage type center contact for UHD signals as 4K or 8K
- Swiss antraloy plating
- Grounded panel mount
- Standard D-shape housing provides flush mounting and protection from damage
- Color coding possible
- Fully compatible with conventional BNC cable connectors

NBB75DFGX

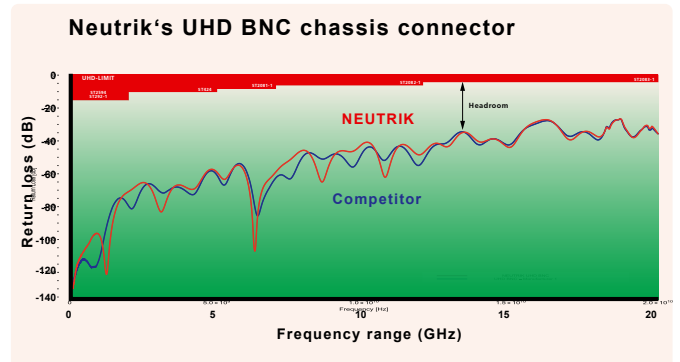
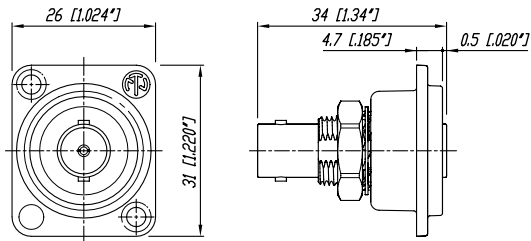

Ordering Information

Antraloy housing

| | |
|-----------|--|
| NBB75DFGX | UHD Bulkhead jack, D-shape housing, feed through, grounded |
| NBB75DFIX | UHD Bulkhead jack, D-shape housing, feed through, isolated |



D-shape metal housing



Gold plated center pin



HD BNC Chassis



NBB75DFG



NBB75DFGB

- True 75 Ω design meets the stringent HDTV / DVD requirements
- Isolated or grounded versions
- "D" shaped housing (provides flush mounting and protection of the jacks from damage) or single feed through mountings
- Gold plated cage type center contact
- Color coding possible

NBB75DFG

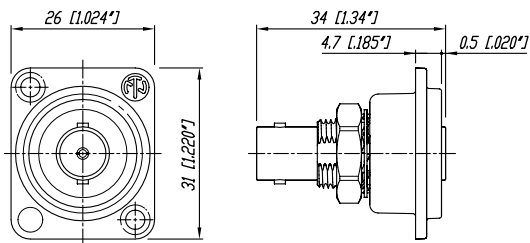

Ordering Information

| Nickel housing | Black housing | Antraloy housing |
|----------------|---------------|--|
| NBB75DFG | NBB75DFGB | Bulkhead jack, D-shape housing, feed through, grounded |
| NBB75DFI | NBB75DFIB | Bulkhead jack, D-shape housing, feed through, isolated |
| NBB75DSG | NBB75DSGB | Bulkhead jack, D-shape housing, solder version, grounded |
| NBB75DSI | NBB75DSIB | Bulkhead jack, D-shape housing, solder version, isolated |



Grounded BNC bulkhead



Isolated BNC bulkhead



HD BNC Cable Jacks Panel Version



Bulkhead Jacks - NBB75FG & NBB75FI

Cable jacks Panel Version – NBB75SI

- True 75 Ω design meets the stringent HDTV / DVD requirements
- Isolated panel mount (solves potential grounding problems and prevents common-mode influence with other connections conducted over the same panel ground potential)
- Gold plated cage type center contact
- Extra wide fastening nut avoids damaging the plastic thread

NBB75FI

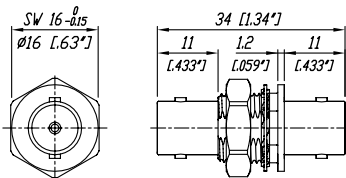

Ordering Information

Nickel housing

| | |
|---------|--|
| NBB75FG | Bulkhead jack, feed through, grounded |
| NBB75FI | Bulkhead jack, feed through, isolated |
| NBB75SI | Bulkhead jack, solder version, including isolation washers |
| NBB75FA | Coupler, feed through |

| Specifications | rearTWIST UHD | rearTWIST HD & rearTWIST HD Large & Cable Jack Panel | rearTWIST HD Tiny & Cable Jack Tiny | Bulkheads & Coupler |
|----------------|------------------|---|---|---------------------------|
|----------------|------------------|---|---|---------------------------|

Electrical

| | | | | | |
|---------------------------------|-------------------------------|-------------------------------|---|------------------------------|------------------------------|
| Impedance | 75 Ω | ● | ● | ● | ● |
| Rated voltage | 500 V ac rms | ● | ● | 250 V ac rms | ● |
| Insulation resistance | > 5 GΩ | ● | ● | ● | ● |
| Dielectric withstanding voltage | 1'500 V ac rms | ● | ● | 750 V ac rms | ● |
| VSWR / Return Loss | ≤ 1.050 / > 32 dB up to 1 GHz | ≤ 1.06 / > 30 dB up to 6 GHz | ● | ≤ 1.10 / > 26 dB up to 1 GHz | ≤ 1.03 / > 37 dB up to 1 GHz |
| | ≤ 1.065 / > 30 dB up to 2 GHz | ≤ 1.13 / > 24 dB up to 12 GHz | ● | ≤ 1.14 / > 24 dB up to 2 GHz | ≤ 1.05 / > 32 dB up to 2 GHz |
| | ≤ 1.100 / > 26 dB up to 3 GHz | ≤ 1.22 / > 20 dB up to 18 GHz | ● | ≤ 1.22 / > 20 dB up to 3 GHz | ≤ 1.08 / > 28 dB up to 3 GHz |
| Inner contact resistance | ≤ 3 mΩ (initial) | ● | ● | ● | ● |
| Outer contact resistance | ≤ 2 mΩ (initial) | ● | ● | ● | ● |

Mechanical

| | | | | | |
|--------------------------|---------------------|-----------|-----------|-----------|-------|
| Cable anchoring | Jacket crimping | ● | ● | ● | N / A |
| Cable O.D. range | mm | 4.3 - 7.3 | 4.0 - 7.7 | 2.5 - 3.8 | N / A |
| | - Rear Twist Large | mm | - | 10.3 | - |
| Center contact retention | > 30 N | ● | ● | ● | - |
| Engagement force | < 25 N | ● | ● | ● | ● |
| Lifetime | 1'000 mating cycles | ● | ● | ● | ● |

Material

| | | | | | |
|------------------|--|-------|-------|-------|---------|
| Shell | Brass (CuZn39Pb3) | ● | ● | ● | ● |
| | Optalloy coated | - | ● | ● | ● |
| | Antraloy coated | ● | - | - | - |
| | PA6 (Push Pull only) | - | N / A | N / A | N / A |
| D-Shape housing: | Zinc diecast (ZnAl4Cu1) gal Ni or black Cr platin | N / A | N / A | N / A | NBB75D* |
| | Antraloy coated | ● | - | - | - |
| Ground contact | Bronze (CuSn6) | ● | ● | ● | - |
| | 0.2 μm AuCo over 2 μm NiP15 | ● | ● | ● | - |
| | Brass (CuZn39Pb3) | - | - | - | ● |
| | OPTALLOY coated | - | - | - | ● |
| Center contact | Brass (CuZn35Pb2) | ● | ● | ● | - |
| | 0.2 μm AuCo or | ● | ● | ● | - |
| | Brass (CuZn39Pb3) | - | - | - | ● |
| | 0.2 μm AuCo | - | - | - | ● |
| Insulator | Teflon PTFE | - | ● | ● | ● |
| | Polypropylen PP | ● | - | - | - |
| Chuck | Polyacetal POM | N / A | N / A | N / A | N / A |
| Insulation Shell | Polyacetal POM | N / A | N / A | N / A | ● |

Environmental

| | | | | | |
|-------------------------------|---------------------------|---|---|---|-------|
| Temperature range | -30 °C to +85 °C | ● | ● | ● | ● |
| Solderability complies with | IEC 68-2-20 | ● | ● | ● | N / A |
| Contact crimpability complies | IEC 60803 and IEC 60352-2 | ● | ● | ● | N / A |

Colour Coded Accessories and Seals



BST-BNC-*



DSS-*



SCF



SCDX



SCCD-W



SCDP-*

| | |
|-----------|--|
| BST-BNC-* | Standard boot for the rearTWIST BNCs in black, 9 different colors available |
| DSS-* | Lettering plate for D Shape bulkheads. |
| SCF | Rubber sealing cover to protect the connector against dust and moisture |
| SCDP-* | D-Size sealing gaskets, color coding (*: 0- black, 2- red, 4- yellow, 5- green, 6- blue, 9- white) |
| SCDX | Hinged cover seals D-size chassis connectors, IP 42 rated |
| SCCD-W | Spring-loaded cover to seals for D-size chassis connectors, IP 65 rated |

*: 0 - Black, 1 - Brown, 2 - Red, 3 - Orange, 4 - Yellow, 5 - Green, 6 - Blue, 7 - Violet, 8 - Grey, 9 - White



Assembly Tools



CAS-BNC-T



CS-BNC-RT



HX-R-BNC



PT-BNC



DIE-R-BNC-*

| | | | |
|------------|---|-------------|---|
| CAS-BNC-T | BNC tool case equipped with HX-R-BNC, PT-BNC: Plier tool, CS-BNC-RT: Stripping tool | CS-BNC-LCV | Coax cable stripper for cable O.D. > 8 mm (NBLC75BVZ17) |
| | Note: Dies have to be ordered separately | DIE-R-BNC-* | Crimp tool die for pin and shield for HX-R-BNC |
| CS-BNC-RT | Coax cable stripper for cable O.D. 2.5 – 8 mm | HX-R-BNC | Crimp tool, frame |
| CS-BNC-LCS | Coax cable stripper for cable O.D. > 8 mm (NBLC75BSX14) | PT-BNC | BNC pliers tool |

Crimp die assignment for HX-R-BNC

| Crimp die | Hex crimp mm | | | Hex crimp inch | | | Center pin mm (square crimp) |
|-----------|--------------|---|---|----------------|---|---|------------------------------|
| | A | B | C | A | B | C | |

rearTWIST HD BNC

| | | | | | | | |
|---------------|------|------|------|-------|-------|-------|-----|
| DIE-R-BNC-PDC | 6.47 | 4.53 | 4.06 | 0.255 | 0.178 | 0.160 | 1.6 |
| DIE-R-BNC-PG | 6.47 | 5.00 | - | 0.255 | 0.197 | - | 1.6 |
| DIE-R-BNC-PJ | 6.47 | 5.41 | - | 0.255 | 0.213 | - | 1.6 |
| DIE-R-BNC-PS | 6.47 | 7.01 | - | 0.255 | 0.276 | - | 1.6 |
| DIE-R-BNC-PU | 6.47 | 7.36 | - | 0.255 | 0.290 | - | 1.6 |
| DIE-R-BNC-PY | 6.47 | 8.23 | - | 0.255 | 0.324 | - | 1.6 |

| Crimp die | Hex crimp mm | | | Hex crimp inch | | | Center pin mm (square crimp) |
|-----------|--------------|---|---|----------------|---|---|------------------------------|
| | A | B | C | A | B | C | |

| | | | | | | | |
|-----------------|------|------|---|-------|-------|---|------------------|
| DIE-R-BNC-X | 9.73 | - | - | 0.383 | - | - | 1.75 (Hex Crimp) |
| DIE-R-BNC-UG | 7.36 | 5.00 | - | 0.290 | 0.197 | - | 1.6 |
| DIE-R-BNC-ZPLUS | 10.0 | - | - | 0.39 | - | - | 1.8 |

rearTWIST UHD BNC

| | | | | | | | |
|----------------|------|------|------|-------|-------|-------|------|
| DIE-R-BNCX-PDG | 6.47 | 5.00 | 4.53 | 0.255 | 0.197 | 0.178 | 1.07 |
| DIE-R-BNCX-PU | 6.47 | 7.36 | - | 0.255 | 0.290 | - | 1.07 |

Definitions, Abbreviations & Useful Information

ELEMENTS

| | |
|-----------|-----------------|
| Ag | Silver |
| Al | Aluminium |
| Au | Gold |
| Co | Cobalt |
| Cr | Chromium |
| Cu | Copper |
| Ni | Nickel |
| P | Phosphorus |
| Pb | Lead |
| Pd | Palladium |
| Sn | Tin |
| Zn | Zinc |
| SS | Stainless Steel |

ALLOYS, PLASTICS, POLYMERS

| | |
|-----------------------|----------------------------------|
| Brass (Alloy) | CuZn39Pb3 |
| Bronze (Alloy) | CuSn6 |
| Ck 67 | Carbon Steel |
| EPDM | Ethylene Propylene |
| GR | Glass Reinforced |
| PA | Polyamide |
| PBTP | Polybutylene Terephthalate |
| POM | Polyacetal |
| PTFE | PolyTetraFluoroEthylene (TEFLON) |
| PUR | Polyurethane |

MEASUREMENT LEGEND

| | |
|-----------|------------------|
| N | Newton |
| Ω | Ohm |
| μ | Micro |
| OD | Outside Diameter |
| m | Meter(s) |
| k | Kilo |

ENGLISH TO METRIC CONVERSIONS



| | | |
|------------------|---------|------------------|
| 1/8 inch | 3.175 | millimeters (mm) |
| 1/4 inch | 6.35 | millimeters (mm) |
| 1 inch | 25.4 | millimeters (mm) |
| | 2.54 cm | 1 inch |
| 1 foot | 30.48 | centimeters (cm) |
| | 0.305 | meter (m) |
| 6 foot | 1.828 | meters (m) |
| 50 foot | 15.24 | meters (m) |
| 100 foot | 30.48 | meters (m) |
| 1000 foot | 304.8 | meters (m) |

METRIC TO ENGLISH CONVERSIONS

| | | |
|---------------------|---------|--------|
| 1 centimeter | 0.3937 | inches |
| 1 meter | 39.37 | inches |
| 3.281 meter | 10 | feet |
| 10 meters | 32.808 | feet |
| 50 meters | 164.041 | feet |
| 100 meters | 328.084 | feet |

OTHER ABBREVIATIONS

| | |
|---|---|
| UL® | Underwriters Laboratories |
| IP Rating | Ingress Protection rating for objects and water ACC IEC529/EN60529 |
| IEC | International Electrotechnical Commission is the international standards and conformity assessment body for all fields of electrotechnology |
|  | UL Recognized Component Mark |

| | |
|---|--|
|  | ENEC – European norms electrical certification, demonstrates compliance with European safety standards. |
|  | VDE Association for Electrical, Electronic and Information Technologies e.V. |
| AWG | American Wire Gauge |

NEUTRIK, crystalCON®, etherCON®, maxCON®, miniCON®, nanoCON®, neutriCON®, opticalCON®, powerCON®, powerCON® TRUE1®, Profi®, rearTWIST®, silentPLUG®, speakON®, TOP®, DiWA®, XIRIUM®, are registered trademarks of Neutrik AG.

Neutrik® Part Number Guide

NC3FAH1-B-0-D

| | | |
|----------------------------|--|--|
| Packaging: | D | Cable connector: bulk packed |
| Assembly: | D | Chassis connector: disassembled push latch |
| Retention: | w/o | Latch lock |
| | -0 | Retention spring |
| | -DA | Asymmetric PUSH |
| | B | Black shell, gold contacts |
| Shell: | BAG | Black shell, silver contacts |
| | 0 | Separate ground contact connected to shell, male only |
| Grounding: | 1 | Pin 1 & panel & shell connected, no separate ground contact |
| | 2 | Separate ground contact connected to shell & panel, separate Pin 1 |
| | E | Additional ground contacts |
| | w/o number | No ground/shell contact (except 4/5 pole), female only |
| | Termination: | H |
| | HL | Lateral left PCB mount |
| | HR | Lateral right PCB mount |
| | L | Solder cups |
| | V | Vertical PCB mount |
| | Y | IDC for wires (no ground) |
| | M3 | Mounting holes with M3 thread |
| | M25 | Mounting holes with M2.5 thread |
| | - | Not applicable |
| Series: | A, AA, B, D, DL, DLX, MPR, P, PX, RX, X, XX | |
| Gender: | F | Female |
| | M | Male |
| Number of Contacts: | 2, 3, 4, 5, 6, 7, 8, 12 | |
| Connector Type: | A | Adapter |
| | AC | powerCON® |
| | B | BNC |
| | C | XLR |
| | D | dummyPLUG |
| | E | etherCON® - RJ45 |
| | F | RCA / CINCH |
| | J (MJ, RJ, SJ) | Jack |
| | K | Cable Assembly |
| | L | speakON® - Loudspeaker |
| | M | Module |
| | O | opticalCON® - Fiber Optic Connector |
| | P | Plug |
| | PP | Patch Panel |
| | R | Circular Connector |
| | T | Transformer |
| | TOP | True Outdoor Protection |

Definitions, abbreviations & useful information see page 19.

Neutrik® Product Line

| | | | | | | | |
|------------------------------|---------------------------------|-----------------------------------|-------------------------------|-----------------------------------|------------------------------------|----------------------------|-------------------------------|
| <p>XLR Connectors</p> | <p>Plugs & Jacks</p> | <p>SpeakON® Connectors</p> | <p>Data Connectors</p> | <p>Circular Connectors</p> | <p>powerCON® Connectors</p> | <p>Patch Panels</p> | <p>Digital Devices</p> |
|------------------------------|---------------------------------|-----------------------------------|-------------------------------|-----------------------------------|------------------------------------|----------------------------|-------------------------------|

NEUTRIK®

The premium brand of the Neutrik Group

LIECHTENSTEIN (HEADQUARTERS)

Neutrik AG, Im alten Riet 143, 9494 Schaan
T +423 237 24 24, F +423 232 53 93, neutrik@neutrik.com

GERMANY / NETHERLANDS / DENMARK / AUSTRIA

Neutrik Vertriebs GmbH, Felix-Wankel-Straße 1, 85221 Dachau, Germany
T +49 8131 28 08 90, neutrik@neutrik.de

GREAT BRITAIN

Neutrik (UK) Ltd., Westridge Business Park, Cothey Way
Ryde, Isle of Wight PO33 1 QT
T +44 1983 811 441, sales@neutrik.co.uk

FRANCE

Neutrik France SARL, 52 rue d'aguesseau, 1er etage, 92100 Boulogne-Billancourt
T +33 1 41 31 67 50, info@neutrik.fr

USA

Neutrik USA Inc., 4115 Taggart Creek Road, Charlotte, North Carolina, 28208
T +1 704 972 3050, info@neutrikusa.com

JAPAN

Neutrik Limited, Yusen-Higashinohonbashi-Ekimae Bldg., 3-7-19
Higashinohonbashi, Chuo-ku, Tokyo 103
T +81 3 3663 47 33, mail@neutrik.co.jp

HONG KONG

Neutrik Hong Kong Ltd., Suite 18, 7th Floor Shatin Galleria
Fotan, Shatin
T +852 2687 6055, sales@neutrik.com.hk

CHINA

Ningbo Neutrik Trading Co., Ltd., Shiqi Street, Yinxian Road West
Fengjia Villiage, Hai Shu Area, Ningbo, Zhejiang, 315153
T +86 574 88250833, sales@neutrik.com.cn

ASSOCIATED COMPANIES

Contrik AG

Steinackerstrasse 35, 8902 Urdorf, Switzerland
T +41 44 736 50 10, contrik@contrik.ch

H. Adam GmbH

Felix-Wankel-Straße 1, 85221 Dachau, Germany
T +49 08131 28 08-0, anfrage@adam-gmbh.de

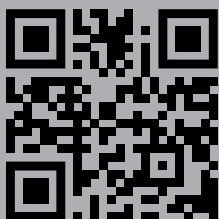

www.neutrik.com